

Plastic Coupling
Polyethylen

Part#	size
PO-350105	1/2"
PO-350107	3/4"
PO-350110	1"
PO-350114	1-1/4"
PO-350115	1-1/2"
PO-350120	2"



Insert Elbow
Polyethylen

Part#	size
PO-350705	1/2"
PO-350707	3/4"
PO-350710	1"
PO-350715	1- 1/2" x 90
PO-350720	2"

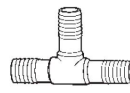

Insert Tee
Polyethylen

Part#	size
PO-351405	1/2"
PO-351407	3/4"
PO-351410	1"
PO-351415	1- 1/2"
PO-351420	2"

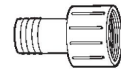

Insert Female
Adapter Polyethylen

Part#	size
PO-350305	1/2"
PO-350307	3/4"
PO-350310	1"
PO-350314	1- 1/4"
PO-350315	1-1/2"
PO-350320	2"

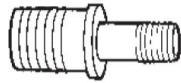

Insert Reducing
Coupling Polyethylen

Part#	size
PO-350116	1 1/2"
PO-350117	1" x 3/4"
PO-350121	2" x 1 1/2"
PO-350140	1- 1/4" x 1"
PO-350150	1- 1/2" x 1"
PO-350154	1- 1/2" x 1- 1/4"
PO-350157	1- 1/2" x 3/4"
PO-350175	3/4" x 1/2"
PO-350220	2" x 1"

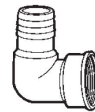

Insert Combination
Elbow Polyethylen

Part#	size
PO-353905	1/2"
PO-353907	3/4"



PVC Nipple

B1-NP8X2	1/2" x 2"
B1-NP8X3	1/2" x 3"
B1-NP8X4	1/2" x 4"

Insert Male
Adapters Polyethylen

Part#	size
PO-350405	1/2"
PO-350407	3/4"
PO-350410	1"
PO-350414	1-1/4"
PO-350415	1-1/2"
PO-350420	2"

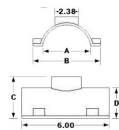

Part#	size	Description	A	B	C	D
P0-PST320	3x2	• Saddle Tee Only	3.4*	5.2*	2.7*	2*
P0-PPK320	3x2	• Saddle Tee Kit- Repair Saddle Clamps & Hardware	3.4*	5.2*	2.7*	2*
P0-PST420	4x2	• Saddle Tee Only	4.5*	6.1*	2.7*	2.5*
P0-PPK420	4x2	• Saddle Tee Kit- Repair Saddle, Clamps & Hardware	4.5*	6.1*	2.7*	2.5*

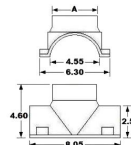

Part#	size	Description	A
P0-PST430	4x3	• Saddle Tee Only	3.4*
P0-PPK430	4x3	• Saddle Tee Kit- Repair Saddle Clamps & Hardware	3.4*
P0-PST440	4x4	• Saddle Tee Only	4.5*
P0-PPK440	4x4	• Saddle Tee Kit- Repair Saddle, Clamps & Hardware	4.5*

Sch. 80 Nipples
(MIP x MIP)



Part#	size
P2-18XCLOSE	1-1/4 x Close
P2-3407001	1- 1/2" x Close
P2-3406001	1- 1/4" x 1- 5/8"



Reducing Bushing
(SPIGOT x FIT)

Part#	size
P2-34255	2" x 1/2"



Reducing Bushing
(SPIGOT x FIT)

Part#	size
P3-D70224	2" x 1- 1/4"



Sanitary Tee
(HUB x HUB x HUB)

Part#	size
P3-D71114	1- 1/4"

PVC Accesories

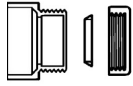

Trap Adapter Female
 P3-D104-012 1- 1/4" x 1- 1/4"
 P3-D104-015 1- 1/2" x 1- 1/2"
 P3-D104-212 1- 1/2" x 1- 1/4"



P3-D321-012
 1/8" Bend Elbow
 PVC 45° DWV 1- 1/4"

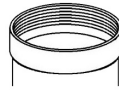

P3-D105-015
 1- 1/2" Fitting
 Clean Out Adapter



P3-D300-012
 1/4" Bend Elbow
 PVC 90° DWV 1-1/4"

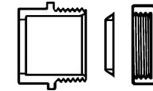

Trap Adapter Male
 P3-D113-012 1- 1/4" x 1- 1/4"
 P3-D113-015 1- 1/2" x 1- 1/2"
 P3-D113-212 1- 1/2" x 1- 1/4"



One Piece Closet Flange Hub
 P3-D800-040 4" x 4"
 P3-D800-422 4" x 3"



PVC Dresser Coupling
 P5-AB4C08 1/2"
 P5-AB4C12 3/4"
 P5-AB4C16 1"
 P5-AB4C18 1-1/4"
 P5-AB4C20 1-1/2"
 P5-AB4C22 2"
 P5-AB4C24 2-1/2"
 P5-AB4C26 3"
 P5-AB4C28 4"
 P5-AB4C30 6"



PVC Ball Valve - Slip
 P6-AB7S08 1/2"
 P6-AB7S12 3/4"
 P6-AB7S16 1"
 P6-AB7S18 1-1/4"
 P6-AB7S20 1-1/2"
 P6-AB7S22 2"
 P6-AB7S24 2-1/2"
 P6-AB7S26 3"
 P6-AB7S28 4"
 P6-770513N 6"



PVC Ball Valve - IPS
 P6-AB7T08 1/2"
 P6-AB7T12 3/4"
 P6-AB7T16 1"
 P6-AB7T18 1-1/4"
 P6-AB7T20 1-1/2"
 P6-AB7T22 2"
 P6-AB7T24 2-1/2"
 P6-AB7T26 3"
 P6-AB7T28 4"



P3-D822-422
 4" x 3" PVC Offset Flange



PVC Union - Slip		PVC Union - IPS	
P5-AB47S08	1/2"	P5-AB47T08	1/2"
P5-AB47S12	3/4"	P5-AB47T12	3/4"
P5-AB47S16	1"	P5-AB47T16	1"
P5-AB47S18	1-1/4"	P5-AB47T18	1-1/4"
P5-AB47S20	1-1/2"	P5-AB47T20	1-1/2"
P5-AB47S22	2"	P5-AB47T22	2"
P5-AB47S24	2-1/2"	P5-AB47T24	2-1/2"
P5-AB47S26	3"	P5-AB47T26	3"
P5-AB47S28	4"	P5-AB47T28	4"

CPVC Accesories

CPVC Tubing
 P4-58520 1/2" x 20'
 P4-58620 3/4" x 20'

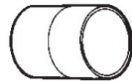

CPVC Coupling
 P4-4120 1/2"
 P4-4340 3/4"



CPVC Reducing Coupling
 P4-4341 3/4" x 1/2"



CPVC Male Adapter
 P4-6120 1/2"
 P4-6340 3/4"



CPVC Caps
 P4-50155 1/2"
 P4-50157 3/4"

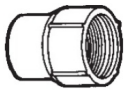

CPVC Female Adapter
 P4-6122 1/2"
 P4-6344 3/4"



CPVC Reducing Bushing
 P4-5027 3/4" x 1/2"

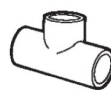

CPVC Tee
 P4-7120 1/2"
 P4-7340 3/4"



CPVC 90° Elbow
 P4-5120 1/2"
 P4-5340 3/4"

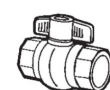

CPVC Ball Valve
 P4-7660-104 1/2"
 P4-7660-105 3/4"



CPVC Compression Coupling
P5-4 CPVC-08 1/2
P5-4 CPVC-12 3/4



CPVC Cement
P9-EZ20701 1/4 PT.
P9-EZ20702 1/2 PT.
P9-EZ20703 1 PT.



Pipe Cleaner Clear
P9-EZ21401 1/4 PT.
P9-EZ21402 1/2 PT.



Q1-TX8
Small Propane Cylinder

Q1-0426-4002 Sk-100 Pencil Flame Torch
Q1-821003 Propane Torch Kit
Q1-LP2KIT Solder Kit



Q4-1848004 Flints In Pack Of 10 Pieces
Q4-13001B Universal Round File Lighter Bulk



Q2-SF-1 901 Silver Flow Brazing Rods 1 Lbs.
Q2-SF-5 5% Silver Brazing Rods 1 Lbs.



Q3-BSP2
2 oz. Burnley Paste



Code	%	Gauge	Description
Q2-100	Pure Tin	- - - 1 Lbs.	Bar (100%)
Q2-20/80SPL	20/80	- 1/8" - 1 Lbs.	Acid Core Solder
Q2-40/60SP	40/60	- 1/8" - 1 Lbs.	Acid Core Solder
Q2-40/60SP1/2	40/60	- 1/8" - 1/2 Lbs.	Acid Core Solder
Q2-50/50BAR	50/50	- 1/8" - 1 Lbs.	Bar Solder
Q2-50/50BAR12	50/50	- 1/8" - 1/2 Lbs.	Bar Solder
Q2-50/50S116	50/50	- 1/16" - 1 Lbs.	Soldering Wire
Q2-50/50SPL	50/50	- 1/8" - 1 Lbs.	Soldering Wire
Q2-50/50SPLA	50/50	- 1/2" - 1/2 Lbs.	Solder Spool
Q2-60/40S1	60/40	- 1/8" - 1 Lbs.	Roll Solid Solder Wire
Q2-95/5SPL	95/5	- 1/8" - 1 Lbs.	Solder Spool
Q2-97/3SPL	97/3	- 1/8" - 1 Lbs.	Solder Spool